

Exercise 8-8

1. Begin a new drawing.
2. Draw the locking pin shown in the following illustration.

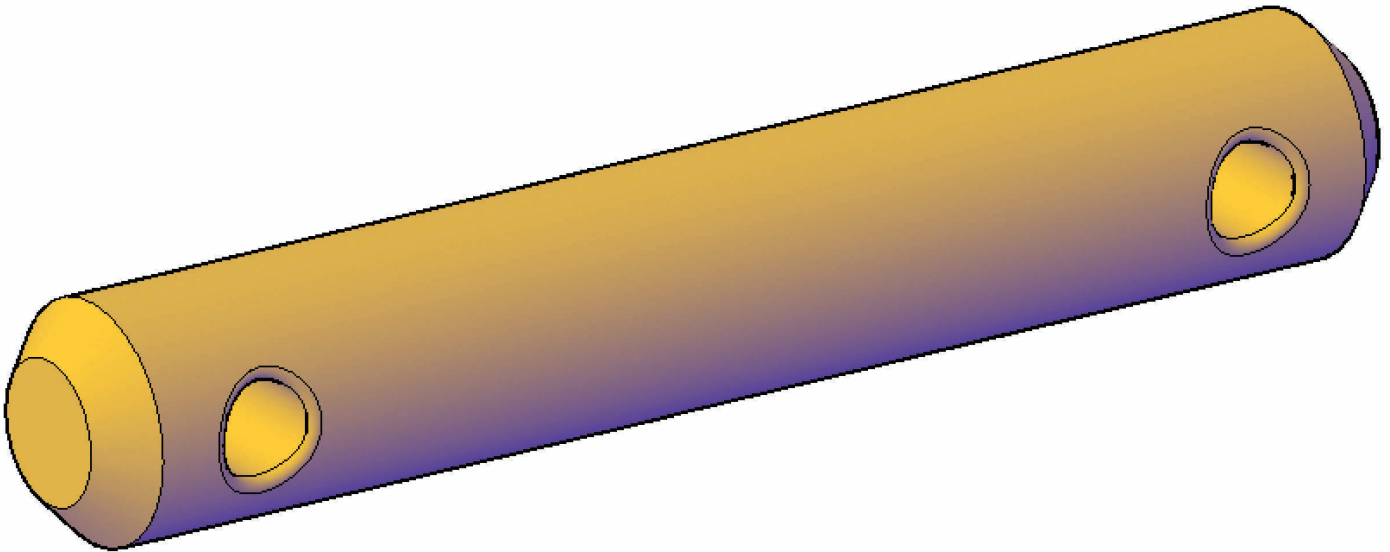

3. The pin is 3" long and $\varnothing.5"$.
4. The two cotter pin holes are $\varnothing.2"$ and their centers are .35" from the end.
5. The chamfer on each end is $.1" \times .1"$ and the fillet on each hole has a .02" radius.
6. When you complete the object, display the object in pictorial and set the Conceptual visual style current.
7. Save the drawing as EX8-8.

To continue practicing chamfering and filleting solids, complete act08-08.dwg available on the companion website.