

Exercise 2-6

See act02-06.dwg available on the companion website.

1. Start a new drawing based on the acad3D.dwt template. Select the 3D Modeling workspace.
2. Using the **RECTANG** and **CIRCLE** commands, draw a two-dimensional top view of the object shown in the following illustration. Use the dimensions given, but do not dimension.

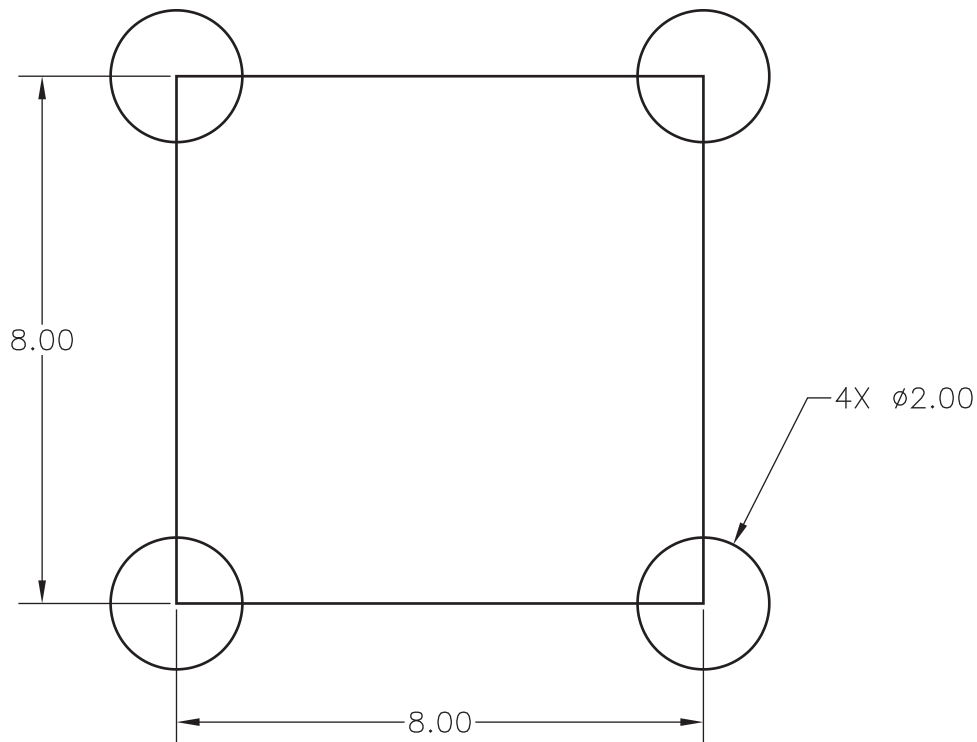

3. Using the appropriate command(s), create a single 2D composite region with externally curved corners.
4. Notice the shape of the region.
5. Calculate the area of the region.
6. Save the drawing as EX2-6.