

## Exercise 29-10

1. Continue from Exercise 29-9 or start AutoCAD.
2. Open the EX29-6 file you saved during Exercise 29-6.
3. Save a copy of EX29-6 as EX29-10. The EX29-10 file should be active.
4. Make the **A-Size** layout current. Be sure you are in paper space, not the floating viewport.

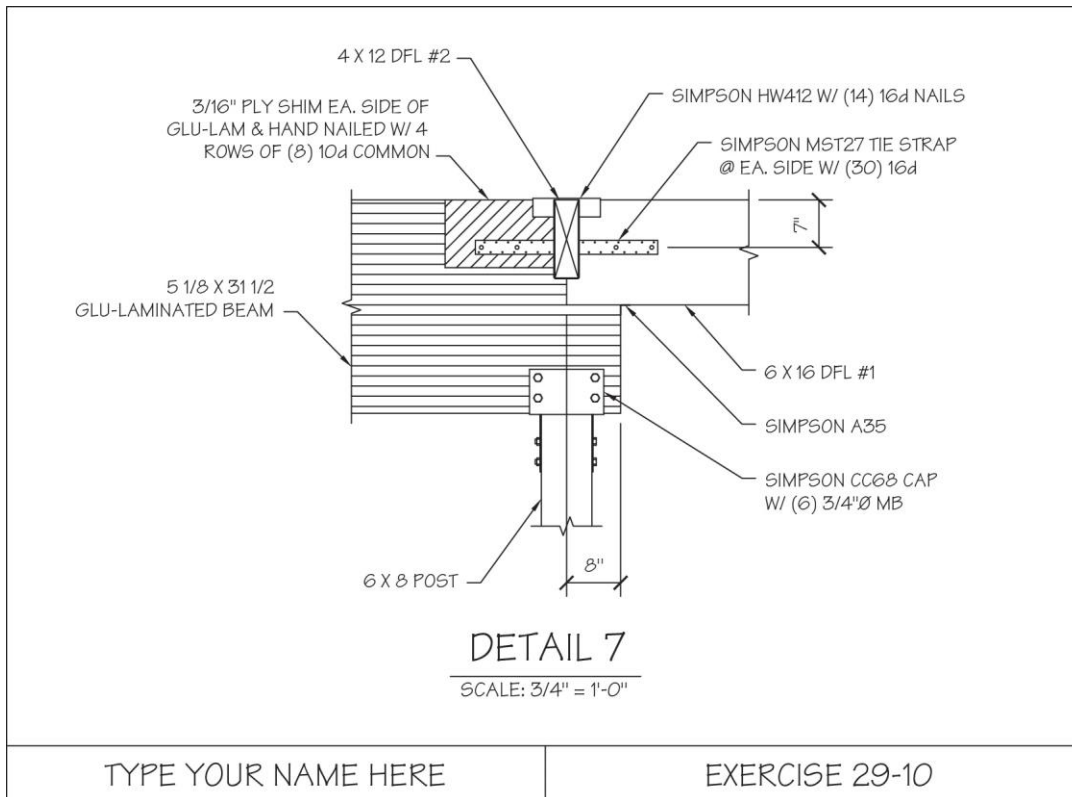

5. On the SHEET layer, add the title and scale shown. Use multiline text and the following settings:
  - STYLUSBT text style
  - Bottom center justification
  - 1/4" text height for the title
  - 1/8" text height for the scale
  - Use the midpoint of the bottom edge of the viewport to position the multiline text boundary
6. Change the title in the title block from EXERCISE 29-5 to EXERCISE 29-10.

7. Freeze the VPORT layer. The drawing should look similar to the drawing shown.
8. Access the **Plot** dialog box and explore the settings and options.
9. Preview the plot.
10. If the preview looks acceptable, send the plot to the selected plot device.
11. Resave and close the file.
12. Keep AutoCAD open for the chapter review and problems, or exit AutoCAD if necessary.