

## Exercise 8-8

1. Begin a new drawing.
2. Draw the locking pin shown in the following illustration.

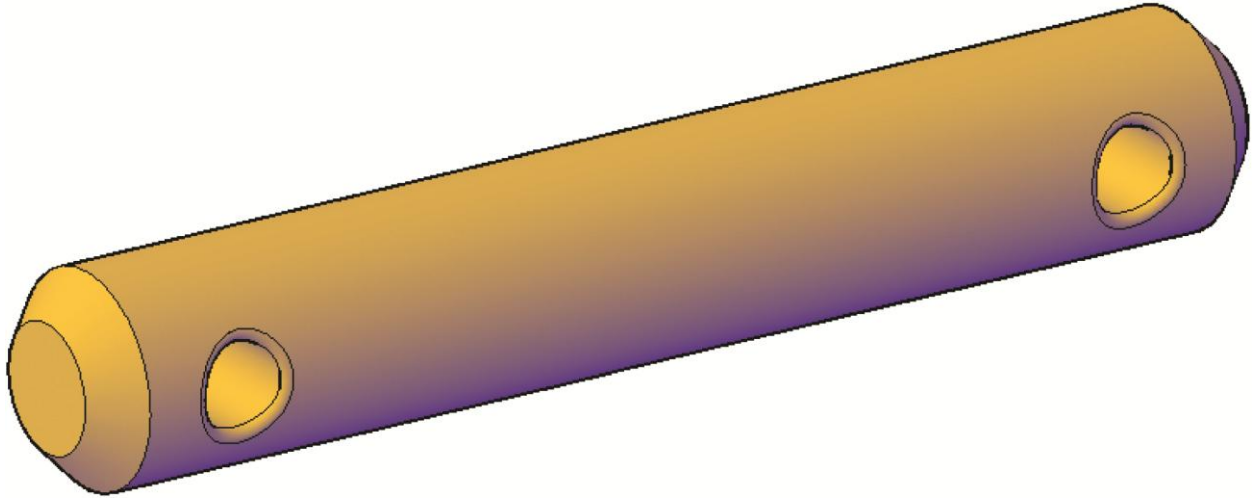

3. The pin is 3" long and  $\text{Ø}.5"$ .
4. The two cotter pin holes are  $\text{Ø}.2"$  and their centers are  $.35"$  from the end.
5. The chamfer on each end is  $.1" \times .1"$  and the fillet on each hole has a  $.02"$  radius.
6. When you complete the object, display the object in pictorial and set the Conceptual visual style current.
7. Save the drawing as EX8-8.

To continue practicing chamfering and filleting solids, complete act08-08.dwg available on the companion website.